

# Growing Likeness | 2024

Growing Likeness | 2024 showcases the creative works of Dr. **Eleanor GATES-STUART**

*Growing Likeness*, a study in biological authored portraiture and a bioart experiment, challenging the growth of human-like structures. A mapping of intelligence systems disguised as human, this research strikes a visual analogy to the science and matrix of crop roots.

Officially opened by Associate Professor **Oron CATTS**

## Gallery25

Opening: Thursday 17 October 2024  
Exhibition dates: 18 October to 13 November 2024  
Floor talk: Wednesday 23 October 12:30pm–1:30pm  
Gallery opening hours: Tuesday to Friday 10am–4pm  
Building 10, 2 Bradford St, Mount Lawley

*ECU Galleries acknowledges the traditional custodians, the Whadjuk Noongar people, and elders past and present. We pay our respects for the great privilege of living, making and researching on these unceded lands.*

ECU Galleries



# Biography

Eleanor Gates-Stuart's interdisciplinary research is diverse and collaborative; her arts practice aligns with science, in unfolding stories of advanced knowledge within the complexity of scientific information and use of future technologies, including historical data. The aim is to find the core elements that trigger creative engagement and experimentation, transferring ideas into artistic output led by interdisciplinary research through the means of science and technology.

This process relates to creative thinking in art and design practice, the intellectualising of thought and research involved in developing an idea and critical reflection in making work, not necessary complex, rather an intrinsic method for establishing dialogue in an interdisciplinary team with a wide range of experiences and differing research fields.

Her scope of artistic creativity and research interests are extensive, multi-perspective, understanding concepts of looking through simple objects, artefacts, with analysis of its deeper meaning in data and visual research. The simplicity creates an open space for research dialogue, an interchange of ideas and entrepreneurial synergy for crossover practice.

Eleanor's collaborative research projects and commissions have received prestigious awards, international and national support, as acknowledged by both Local, State and Federal Government. Her international profile and research roles include, professor, visiting fellow, curator, exhibitor, director of media and science arts events. A regular contributor to numerous professional associations, collaborating, publishing and presenting papers in UK, US, Taiwan & Australia.

Now based in WA, she is currently an Honorary Professor, School of Arts and Humanities, Edith Cowan University, and a Professor (Adjunct), School of Social Work and the Arts, Charles Sturt University and often works in collaboration with major research organisations, museums, and education. She completed her PhD at the Australian National Centre Public Awareness of Science, the Australian National University (Art + Science), in association with the Commonwealth Scientific and Industrial Research Organisation (CSIRO).

## Contact Information

Email: [egs@eleanorgatestuart.com.au](mailto:egs@eleanorgatestuart.com.au)

Instagram: @eleanorgatestuart | @portrait\_institute

Website: <https://eleanorgatestuart.com> | <https://portrait.institute>

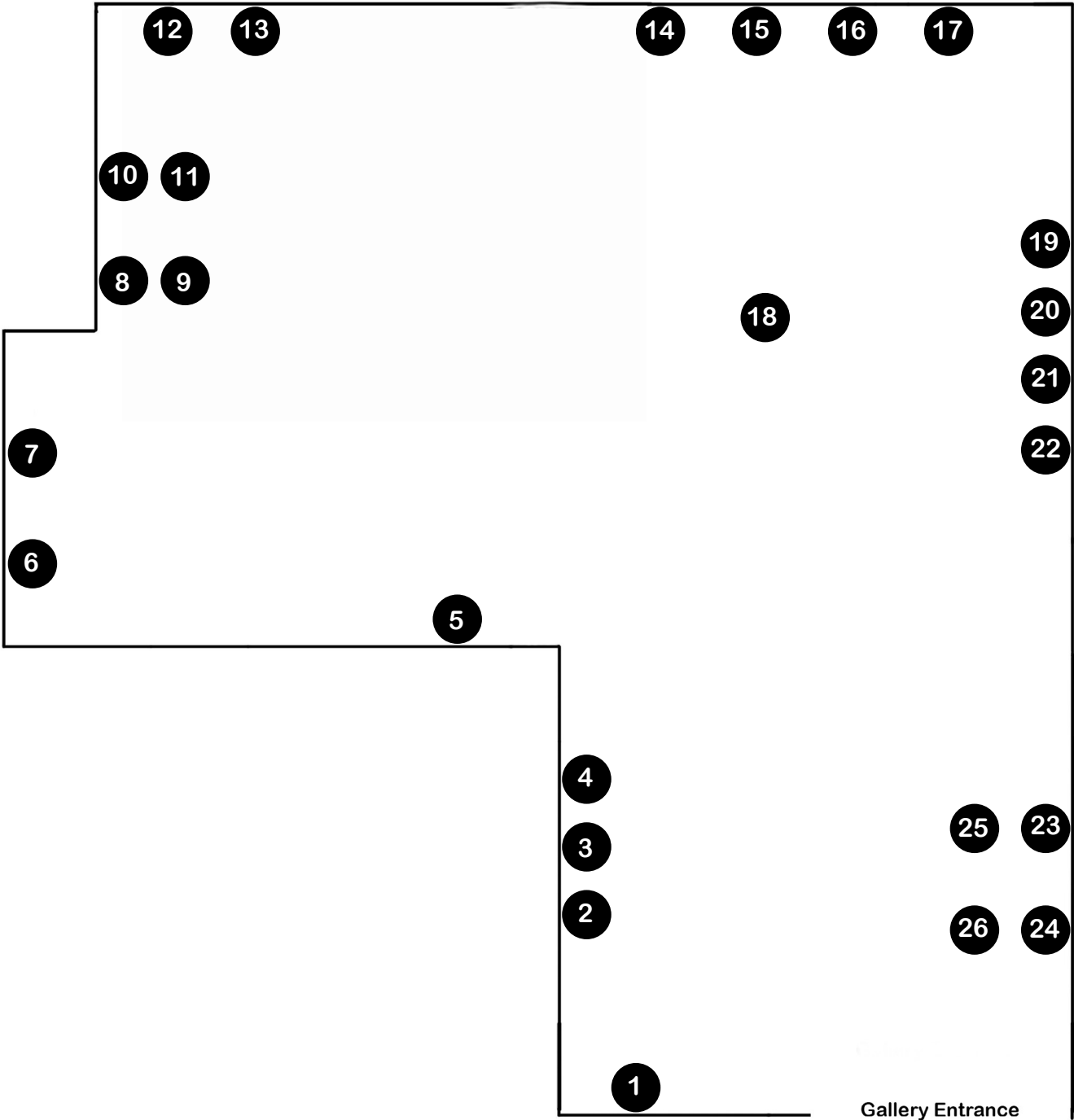

## List of Works

- 1 Synthesising Canola Roots — Tracking Patterns**, 2021,  
pigment ink on archival paper, 100 x 100cm.  
\$750
- 2 Mutation Series: Red #1**, 2024,  
resin portrait with limestone, 40 x 20 x 30cm.  
\$350
- 3 Mutation Series: Red #2**, 2024,  
resin portrait with limestone, 40 x 20 x 30cm.  
\$350
- 4 Mutation Series: Red #3**, 2024,  
resin portrait with limestone, 40 x 20 x 30cm.  
\$350
- 5 Bio-Portrait Identities Series — Mutant**, 2024,  
pigment ink on archival paper, 100 x 100cm.  
\$750
- 6 Canola Growth Production Series (Experiment 1 – #1)**, 2021–2024,  
pigment ink on archival paper, 100 x 100cm.  
\$750
- 7 Canola Growth Production Series (Experiment 1 – #2)**, 2021–2024,  
pigment ink on archival paper, 100 x 100cm.  
\$750
- 8** Left to Right :
  - Self Reflection Series Root Matrix 1**, 2024,  
back-lit mirror glass engraving, 20 x 20 x 10cm.  
\$300
  - Self Reflection Series Root Matrix 2**, 2024,  
back-lit mirror glass engraving, 20 x 20 x 10cm.  
\$300
  - Self Reflection Series Root Matrix 3**, 2024,  
back-lit mirror glass engraving, 20 x 20 x 10cm.  
\$300
  - Self Reflection Series Root Matrix 4**, 2024,  
back-lit mirror glass engraving, 20 x 20 x 10cm.  
\$300

**9** Left to Right :

**Self Reflection Series ID Screen 1, 2024,**  
back-lit mirror glass engraving, 20 x 20 x 10cm.  
\$300

**Self Reflection Series ID Screen 2, 2024,**  
back-lit mirror glass engraving, 20 x 20 x 10cm.  
\$300

**Self Reflection Series ID Screen 3, 2024,**  
back-lit mirror glass engraving, 20 x 20 x 10cm.  
\$300

**Self Reflection Series ID Screen 4, 2024,**  
back-lit mirror glass engraving, 20 x 20 x 10cm.  
\$300

**10** Left to Right :

**Bio-Portrait Sketches Sketches — Red Bio-Marker Canola, 2024,**  
ink and reflective paint on glass, 35 x 35cm.  
\$200

**Bio-Portrait Sketches Sketches — Yellow Bio-Marker Canola, 2024,**  
ink and reflective paint on glass, 35 x 35cm.  
\$200

**Bio-Portrait Sketches Sketches — Green Bio-Marker Canola, 2024,**  
ink and reflective paint on glass, 35 x 35cm.  
\$200

**Bio-Portrait Sketches Sketches — Pink Bio-Marker Canola, 2024,**  
ink and reflective paint on glass, 35 x 35cm.  
\$200

**11** Left to Right :

**Bio-Marker Sketches — Tracking Wheat #2, 2024,**  
ink and reflective paint on glass, 35 x 35cm.  
\$200

**Bio-Marker Sketches — Tracking Wheat #3, 2024,**  
ink and reflective paint on glass, 35 x 35cm.  
\$200

**Bio-Marker Sketches —Tracking Wheat #4**, 2024,  
ink and reflective paint on glass, 35 x 35cm.  
\$200

**Bio-Marker Sketches — Tracking Wheat #1**, 2024,  
ink and reflective paint on glass, 35 x 35cm.  
\$200

**12 Bio-Portrait Identities Series — Grid**, 2024,  
pigment ink on archival paper, 100 x 100cm.  
\$750

**13 Bio-Portrait Identities Series — Face**, 2024,  
pigment ink on archival paper, 100 x 100cm.  
\$750

**14 Bio-Portrait 1 (right) — Canola**, 2021,  
pigment ink on archival paper, 100 x 100cm.  
\$750

**15 Bio-Portrait 1 (front) — Canola**, 2021,  
pigment ink on archival paper, 100 x 100cm.  
\$750

**16 Bio-Portrait 1 (back) — Canola**, 2021,  
pigment ink on archival paper, 100 x 100cm.  
\$750

**17 Bio-Portrait 1 (left) — Canola**, 2021,  
pigment ink on archival paper, 100 x 100cm.  
\$750

**18 Harvested, Artefacts: Bio Portrait Casts x 8**, 2024,  
installation root matrix, canola leaves and soil, 183 x 57 x 122cm.  
POA

**19 Mapping Roots Series — Blue**, 2024,  
wood carving and paint, 100 x 100cm.  
\$2000

**20 Mapping Roots Series — Pink**, 2024,  
wood carving and paint, 100 x 100cm.  
\$2000

- 21 Mapping Roots Series — Red, 2024,**  
wood carving and paint, 100 x 100cm.  
\$2000
- 22 Mapping Roots Series — Yellow, 2024,**  
wood carving and paint, 100 x 100cm.  
\$2000
- 23 Bio-Portrait Identities Series — Systems, 2024,**  
pigment ink on archival paper, 100 x 100cm.  
\$750
- 24 Bio-Portrait Identities Series — Surface, 2024,**  
pigment ink on archival paper, 100 x 100cm.  
\$750
- 25 Bio-Portrait Identities Series — Skin, 2024,**  
pigment ink on archival paper, 100 x 100cm.  
\$750
- 26 Canola Growth Tracking, 2024,**  
pigment ink on archival paper, 100 x 100cm.  
\$750